



연회장(Venue) & 메뉴(Meun) 소개서

Sales Marketing 김현석 팀장

문의 010.5354.2990

Banquet Information (연회장 정보)

CREST 72

Floor	Distinction	PY	gross area (㎡)	total maximum (양식 코스 기준)	Note
별관(3F)	Glass Hall (글라스 홀)	260 PY	858	530 명	대형 LED 보유 음향 & 조명장비 보유 데스크탑 보유
별관(3F)	Garden Hall (가든 홀)	113 PY	375	100 명	음향장비 보유
본관2F	Marie Hall (마리에 홀)	86 PY	286	120 명	음향 & 조명 장비 보유
본관 4F	Mirae Hall (미래 홀)	82 PY	272	180 명	음향장비 보유
본관 4F	Coner Banquet Hall (코너방켓 홀)	58 PY	192	72 명	음향장비 보유
본관 4F	Banquet Hall (방켓 홀)	254 PY	840	500 명	음향장비 보유

Food & Beverage_Menu

	Distinction	Price(won)	Note
Western Set Menu	안심&전복 STK	121,000	안심&전복 스테이크 외 5종
	안심 STK	96,800	안심 스테이크 외 5종
	등심 STK	88,000	등심 스테이크 외 5종
	부채살 STK	77,000	부채살 스테이크 외 5종
퓨전 한식 코스	한식 STK	121,000	소고기&전복 연잎밥 외 5종

	Distinction	Price(won)	Note
Buffet	A Type	88,000	40여종의 한식, 중식, 양식, 일식, 디저트 등의 메뉴구성 (계절이나 식자재 수급에 따라 메뉴 변동 가능)
	B Type	96,800	
	C Type	121,000	

상기 봉사료+VAT 금액 포함가

Price (대관료)

구분	장소	면적	1시간당 대관료	오전		오후		ALL DAY		비고
				시간	08:00~12:00	시간	13:00~22:00	시간	08:00~22:00	
보유공간	글라스홀	260평	5,000,000	시간	08:00~12:00	시간	13:00~22:00	시간	08:00~22:00	별관
				대관료	10,000,000	대관료	40,000,000	대관료	50,000,000	
	가든	113평	2,000,000	시간	08:00~12:00	시간	13:00~22:00	시간	08:00~22:00	별관
				대관료	5,000,000	대관료	10,000,000	대관료	15,000,000	
	마리에홀	86평	2,000,000	시간	08:00~12:00	시간	13:00~22:00	시간	08:00~22:00	본관2층
				대관료	3,000,000	대관료	7,000,000	대관료	10,000,000	
	미래홀	82평	2,000,000	시간	08:00~12:00	시간	13:00~22:00	시간	08:00~22:00	본관4층
				대관료	3,000,000	대관료	7,000,000	대관료	10,000,000	
	코너방켄	58평	1,000,000	시간	08:00~12:00	시간	13:00~22:00	시간	08:00~22:00	본관4층
				대관료	2,000,000	대관료	5,000,000	대관료	7,000,000	
	메인방켄	254평	3,000,000	시간	08:00~12:00	시간	13:00~22:00	시간	08:00~22:00	본관4층
				대관료	5,000,000	대관료	10,000,000	대관료	15,000,000	
	연습실 A		500,000	시간	08:00~12:00	시간	13:00~22:00	시간	08:00~22:00	가든 본관2층
				대관료	1,000,000	대관료	4,000,000	대관료	5,000,000	
	연습실 B		500,000	시간	08:00~12:00	시간	13:00~22:00	시간	08:00~22:00	본관3층
				대관료	1,000,000	대관료	4,000,000	대관료	5,000,000	

별관 Glass Hall (글라스 홀)

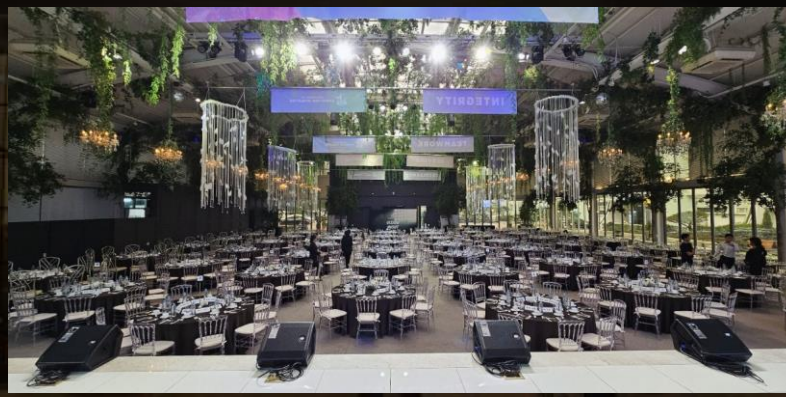
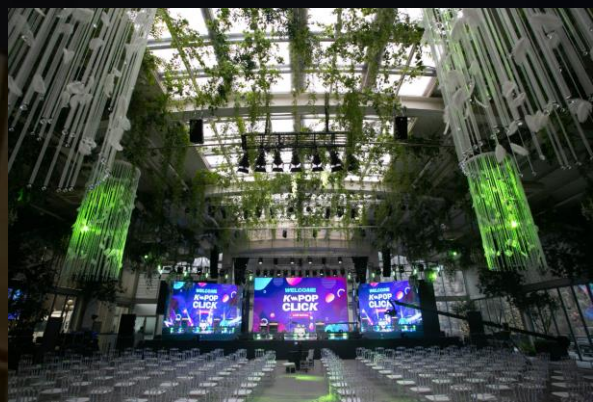

별관 Glass Hall (글라스 홀)_Layout

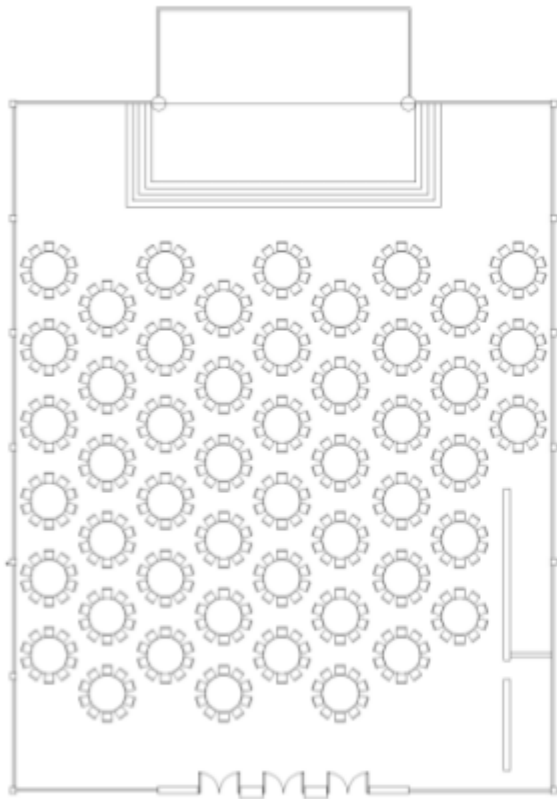

Banquet
500 persons

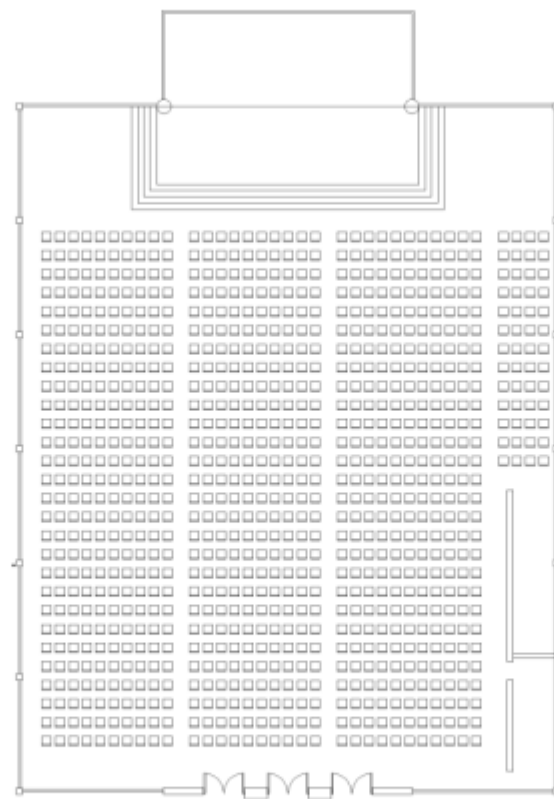

Theater
892 persons

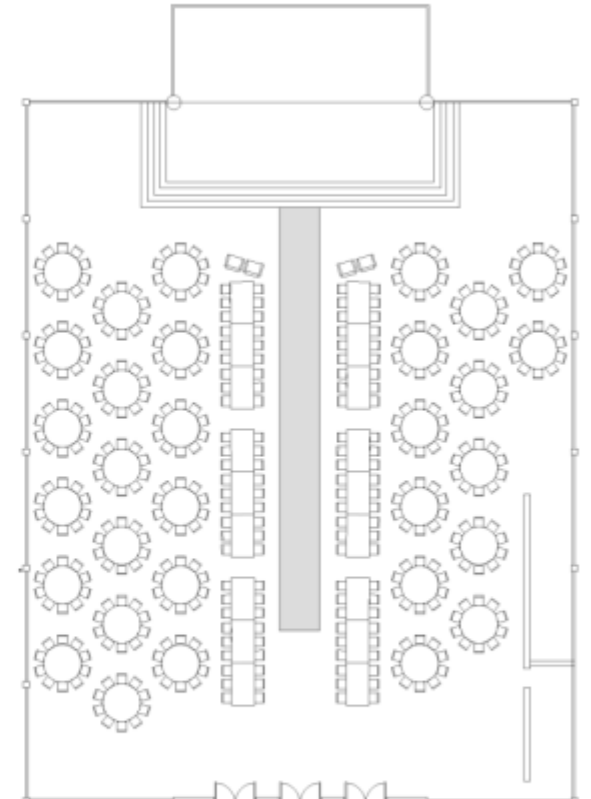

Wedding
418 persons

별관 Glass Hall (글라스 홀)_System

Scale 규모

W+ L+ H(m/홀 전용면적)	SQ.M(m2/홀 전용 + 공용면적)	Pyung
26*33*8	858	260

Lighting System 조명

Descriptions	Brand/Model	Qty.
LED Moving Spot Light	300W/VaderPro350	12
LED Moving Wash	M28A	12
LED Fresnel	200MZ-Cw	11
LED Par		40
Beam 230		8

Video System 영상

Descriptions	Brand/Model	Qty.
웨딩 시스템		
PTZ Camera	ED-P20N	2
Camera Controller	ED-EPC9000	1
HD Switcher	LUMARTEK	1
Multiview Monitor		
SDI to HDMI컨버터	LUMARTEK	2
SDI Distributor		
TV 모니터LED		
Display(무대)	10,000×5,000(mm)	1
LED Display(사이드)	243*439(cm)	1
LED Controller	NOVASTAR (4)	2
PC		1
전원분배 제어장치		1

Audio System 음향

Descriptions	Brand/Model	Qty.
무선마이크	SHURE.SLXD2	8
무선마이크 리시버	SHURE.SLXD4	8
유선마이크	SHURE.SM137	3
Gooseneck Mic	SHURE.MX418 D/S	3
음향콘솔	MIDAS. M32	1
Amplifier(Main)	RCF. HPS 2500	2
음악소스용기기	NUMARK. MP-103 USB	2
Speaker(Main L/R)	RCF. HDL 6-A	12
Speaker(Woofer)	RCF. HDL 12-AS	4
Delay Speaker	RCF. C5212-96	4
Monitor Speaker	RCF. NX10-SMA	4

야외 Garden Hall (가든 홀)

REST 72

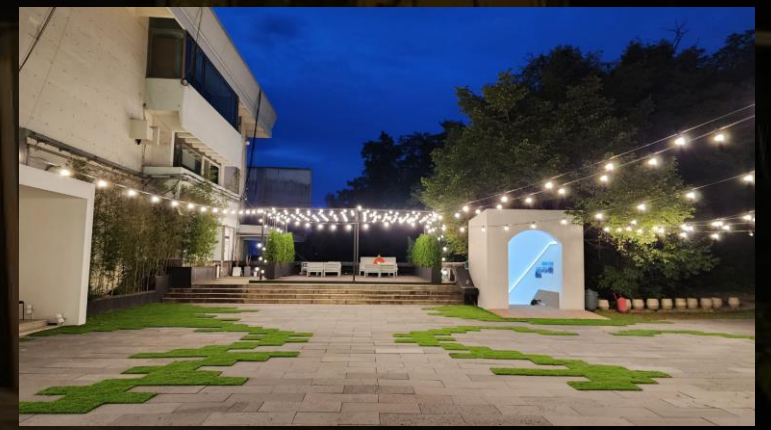

야외 Garden Hall (가든 홀)_Layout

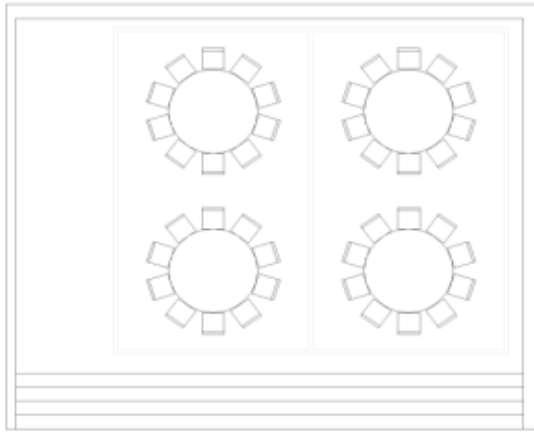

Round
40 persons

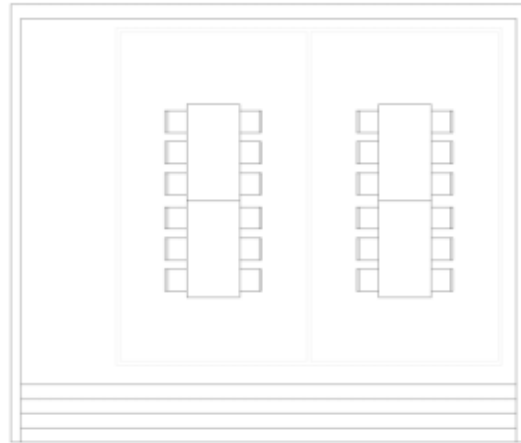

Square1
24 persons

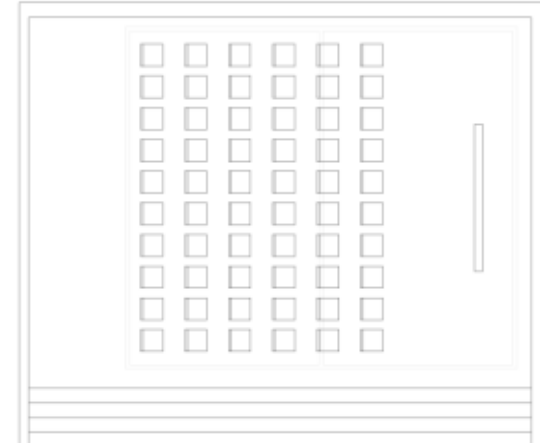

Theater
60 persons

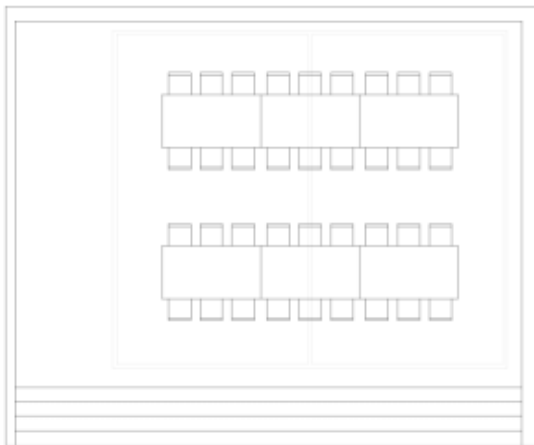

Square2
36 persons

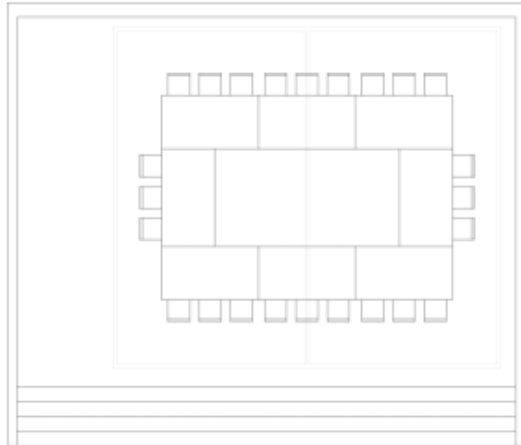

Hollow Shape
24 persons

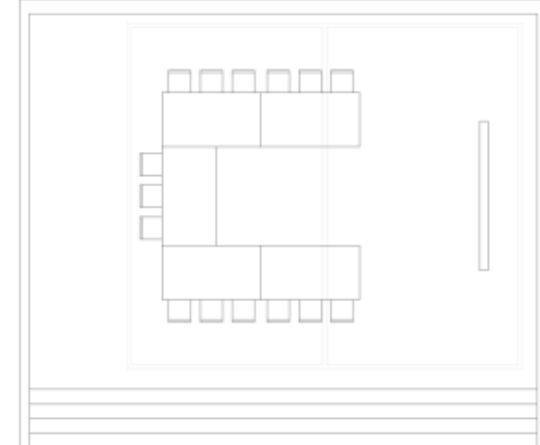

U Shape
15 persons

야외 Garden Hall (가든 홀)_System

Scale 규모

W+L+H(m/홀 전용면적)	SQ.M(m2/홀 전용 + 공용면적)	Pyung
25*15	375	113

Video System 영상

Descriptions	Brand/Model	Qty.
웨딩 시스템	-	-
PTZ Camera		
Camera Controller		
HD Switcher		
Multiview Monitor		
SDI to HDMI 컨버터		
SDI Distributor		
TV 모니터 LED		
Display(무대)		
LED Display(사이드)		
LED Controller		
PC		
전원분배 제어장치		

Lighting System 조명

Descriptions	Brand/Model	Qty.
LED Spot Light	-	-
LED Moving Spot Light		
LED Moving Wash		
LED Fresnel		
LED Par		
Beam 230		

Audio System 음향

Descriptions	Brand/Model	Qty.
무선마이크	TX-900HM	2
무선마이크 리시버	RX-902M	1
유선마이크	D-8	6
음향콘솔	X32 COMPACT	1
Amplifier(Main)	LX-3.6	1
Amplifier(Back)	LX-1.5	1
Speaker	8/400W	2

본관 2층 Marie Hall (마리에 홀)

REST 72



본관 2층 Marie Hall (마리에 홀)_Layout

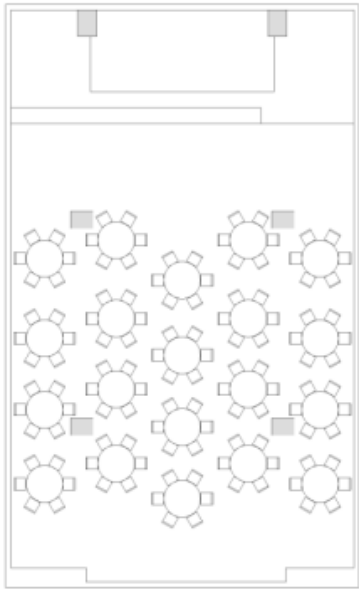

Banquet
120 persons

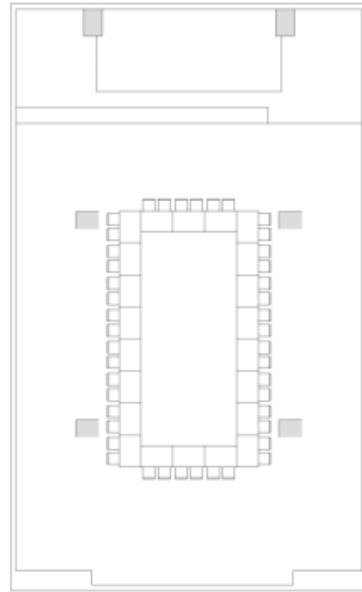

Hollow Shape
44 persons

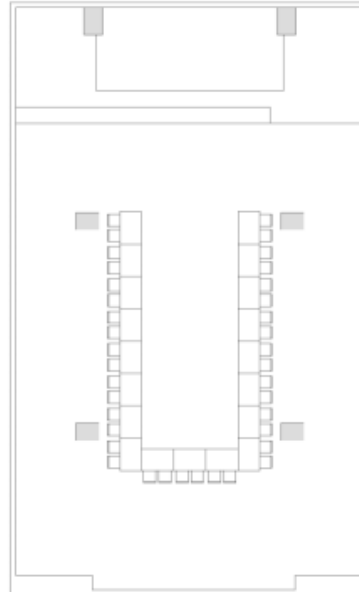

U Shape
38 persons

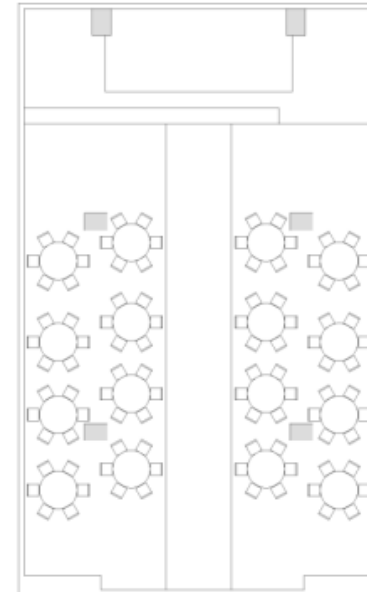

Wedding
96 persons

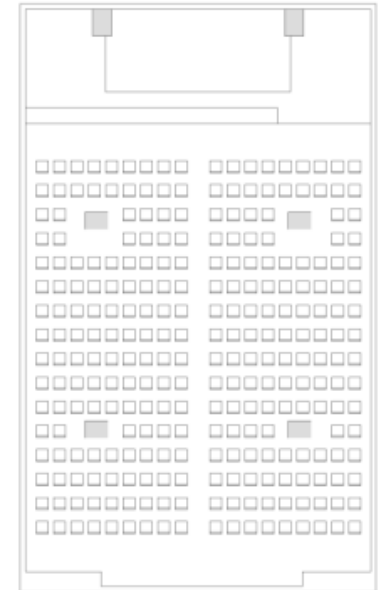

Theater
270 persons

본관 2층 Marie Hall (마리에 홀)_System

Scale 규모

W+L+H(m/홀 전용면적)	SQ.M(m2/홀 전용 + 공용면적)	Pyung
13*22*3.5	286	86

Video System 영상

Descriptions	Brand/Model	Qty.
웨딩 시스템		1
PTZ Camera	ED-P20N	2
Camera Controller	ED-EPC9000	1
HD Switcher	LUMARTEK	1
Multiview Monitor		1
SDI to HDMI컨버터	LUMARTEK	1
SDI Distributor	NMS-0112	2
TV 모니터LED		1
Display(무대)		
LED Display(사이드)		
LED Controller		
PC		
전원분배 제어장치		

Lighting System 조명

Descriptions	Brand/Model	Qty.
LED Spot Light	OP200FZ/3200K	23
LED Moving Spot Light		
LED Moving Wash		
LED Fresnel		
LED Par		
Beam 230		

Audio System 음향

Descriptions	Brand/Model	Qty.
무선마이크	TX-900HM	2
무선마이크 리시버	RX-902M	1
증폭기	EX-909A	2
유선마이크	D-8	2
Gooseneck Mic	JGM-918	3
음향콘솔	X32 COMPACT	1
Amplifier(Main)	LX-1.5	2
Speaker	벽부형/200W	4

본관4층 Mirae Hall (미래 홀)

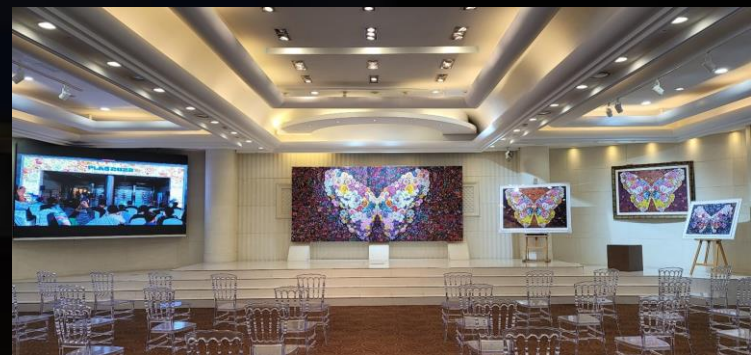

본관4층 Mirae Hall (미래 홀)_Layout

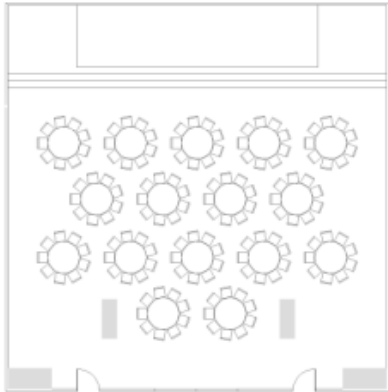

Banquet
144 persons

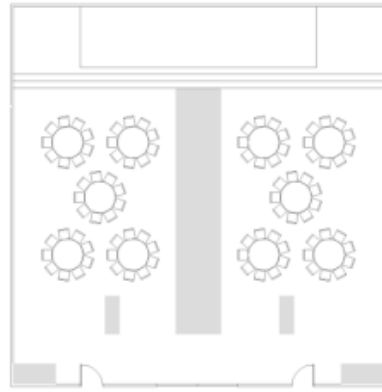

Wedding
90 persons



Class Room
72 persons

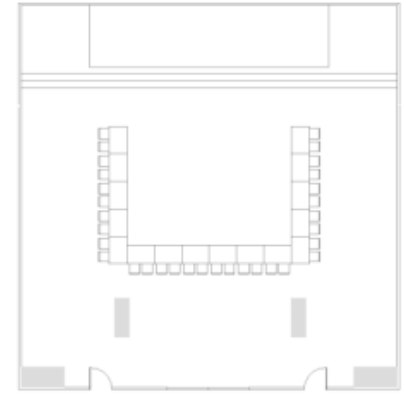

U Shape
32 persons

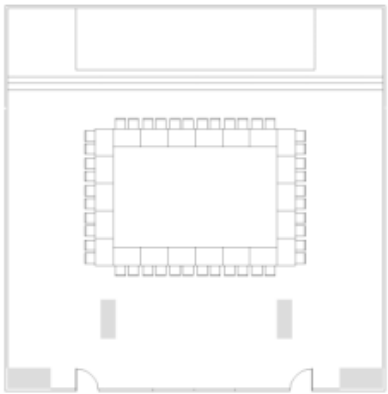

Hollow Shape
44 persons

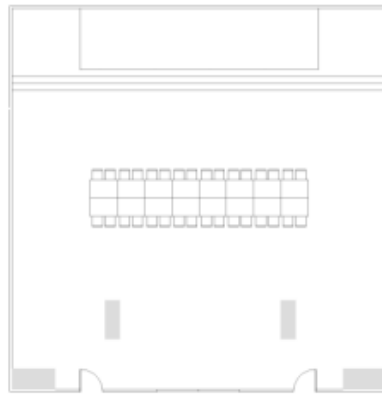

I Shape
32 persons

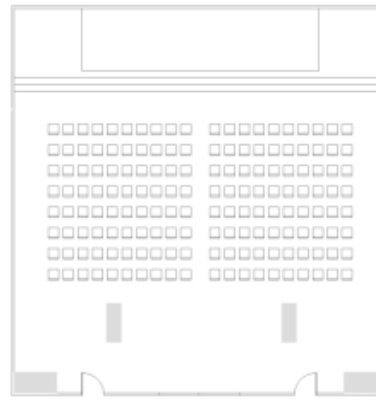

Theator
160 persons

본관4층 Mirae Hall (미래 홀)_System

Scale 규모

W+L+H(m/홀 전용면적)	SQ.M(m2/홀 전용 + 공용면적)	Pyung
16*17*3.5	272	82

Video System 영상

Descriptions	Brand/Model	Qty.
웨딩 시스템		
PTZ Camera		
Camera Controller		
HD Switcher		
Multiview Monitor		
SDI to HDMI컨버터		
SDI Distributor		
TV 모니터LED		
Display(무대)		
LED Display(사이드)	192*346(cm)	1
LED Controller		1
PC		
전원분배 제어장치		

Lighting System 조명

Descriptions	Brand/Model	Qty.
LED Spot Light	-	-
LED Moving Spot Light		
LED Moving Wash		
LED Fresnel		
LED Par		
Beam 230		

Audio System 음향

Descriptions	Brand/Model	Qty.
무선마이크	TX-900HM	2
무선마이크 리시버	RX-900M	2
음향콘솔	X32 COMPACT	1
Amplifier(Main)	LX-1.5	1
Speaker(Main L/R)	벽부형/90W/CSB-175	4

본관4층 Coner Banquet Hall (코너 방켄홀)

REST 72

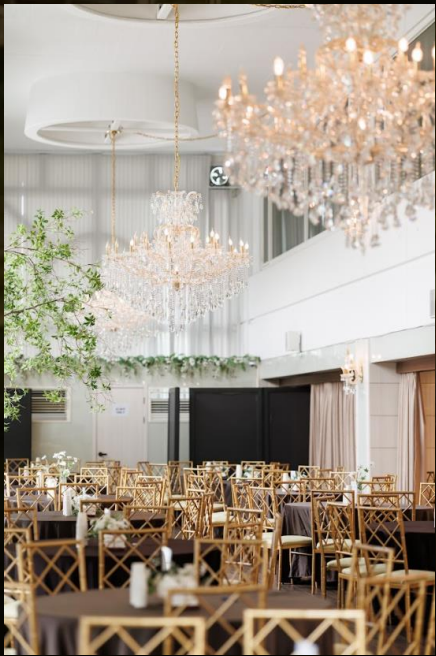

본관4층 Coner Banquet Hall (코너 방켄홀)_Layout

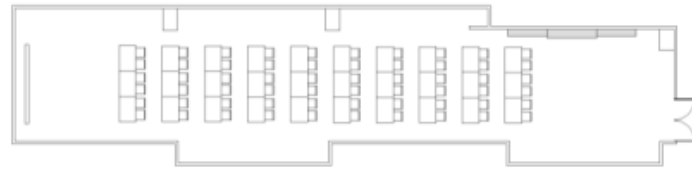

Classroom
60 persons

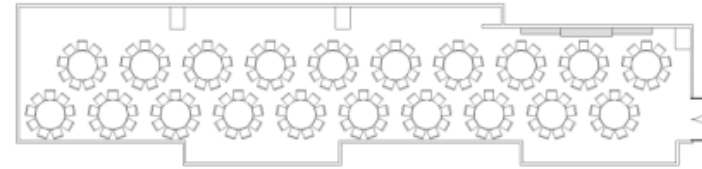

Banquet
180 persons

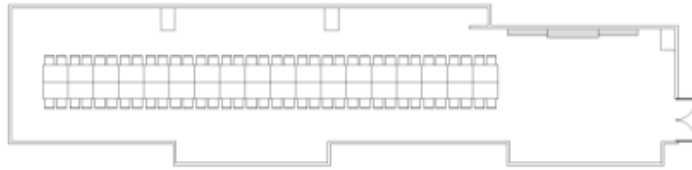

I Shape
72 persons

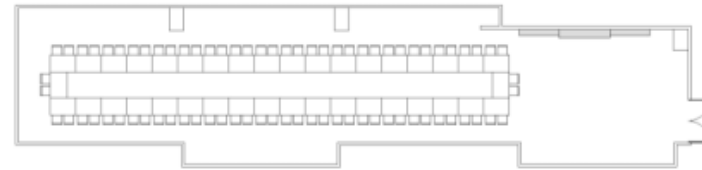

Hollow Shape
76 persons

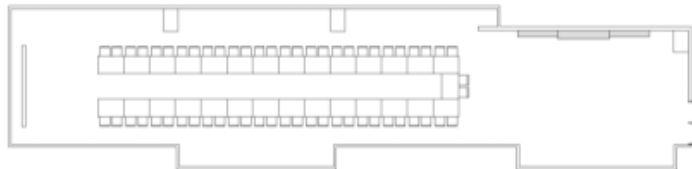

U Shape
58 persons

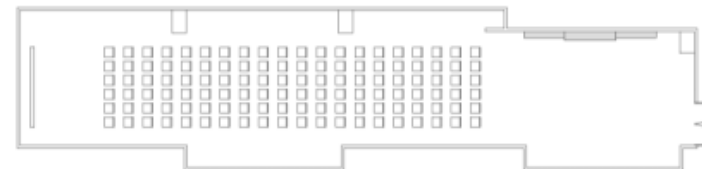

Theater
120 persons

본관4층 Coner Banquet Hall (코너 방켓홀)_System

Scale 규모

W+L+H(m/홀 전용면적)	SQ.M(m2/홀 전용 + 공용면적)	Pyung
6*32*6.5	192	58

Lighting System 조명

Descriptions	Brand/Model	Qty.
LED Spot Light	-	-
LED Moving Spot Light		
LED Moving Wash		
LED Fresnel		
LED Par		
Beam 230		

Video System 영상

Descriptions	Brand/Model	Qty.
웨딩 시스템	-	-
PTZ Camera		
Camera Controller		
HD Switcher		
Multiview Monitor		
SDI to HDMI컨버터		
SDI Distributor		
TV 모니터LED		
Display(무대)		
LED Display(사이드)		
LED Controller		
PC		
전원분배 제어장치		

Audio System 음향

Descriptions	Brand/Model	Qty.
음향콘솔	메인 방켓에서 조정	
Amplifier(Main)	LX-1.5	1
음악소스용기기	CDR-3000	1
Speaker	CSB-150	4

본관4층 Main Banquet Hall (메인 방켄홀)

REST 72



본관4층 Main Banquet Hall (메인 방켄홀)_Layout

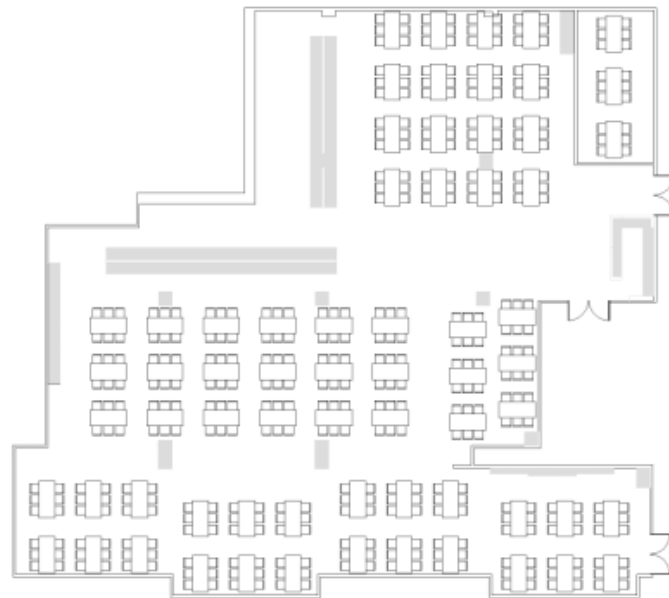

Square
400 persons

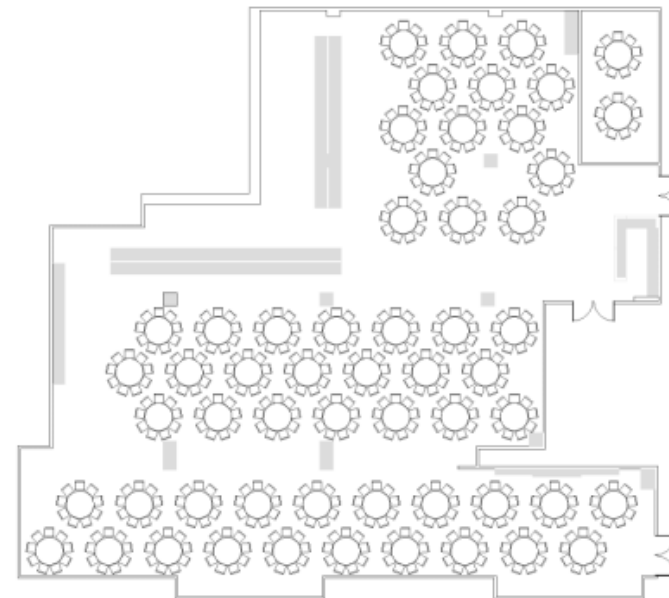

Round
513 persons

본관4층 Main Banquet Hall (메인 방켓홀)_System

Scale 규모

W+L+H(m/홀 전용면적)	SQ.M(m2/홀 전용 + 공용면적)	Pyung
28*30*3	840	254

Lighting System 조명

Descriptions	Brand/Model	Qty.
LED Spot Light	-	-
LED Moving Spot Light		
LED Moving Wash		
LED Fresnel		
LED Par		
Beam 230		

Video System 영상

Descriptions	Brand/Model	Qty.
웨딩 시스템	-	-
PTZ Camera		
Camera Controller		
HD Switcher		
Multiview Monitor		
SDI to HDMI컨버터		
SDI Distributor		
TV 모니터LED		
Display(무대)		
LED Display(사이드)		
LED Controller		
PC		
전원분배 제어장치		

Audio System 음향

Descriptions	Brand/Model	Qty.
음향콘솔	MG124cx	1
Amplifier(Main)	V-6	1
Amplifier(Back)	AL-300	1
Speaker	ALNICO	5



Hyun Suk, Kim | Purchasing / Sales Team Leader

김 현 석 | 세일즈 팀장

M. 010.5354.2990

E. k608170@hanmail.net

T. 02.2232.7366

F. 02.2232.7355

72, Jangchungdan-ro, Jung-gu, Seoul, Republic of Korea

www.crest72.co.kr